



**EXTRA HEFT TO EXTEND
SERVICE LIFE IN
CONTINUOUS-USE
APPLICATIONS**

BUCKET ELEVATORS

*up to 630 ft³/h
(17 m³/h)
500 BPH*

EXCLUSIVE “EASY DUMP®” DESIGN
(U1TT-220ED only)

SPECIFICATIONS

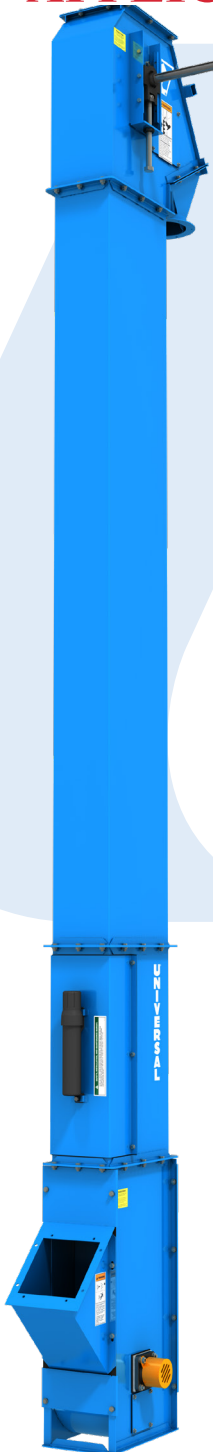

Model	U1TT-220ED	U1TT-630
Capacity - Free Flowing Material @ 110% Waterline Bucket Fill	175 BPH 220 ft ³ /hr 6 m ³ /hr	500 BPH 630 ft ³ /hr 17 m ³ /hr
Short TPH @ 50 lbs/Ft. ³	5	15
MTPH @ 50 lbs/Ft. ³	4	13
Short TPH @ 75 lbs/Ft. ³	8	23
MTPH @ 75 lbs/Ft. ³	7	20
Belt Speed FPM	118 (0.60m/s)	236 (1.2m/s)
Head Shaft RPM	86	172
Bucket Spacing	4-1/4" (107.95mm) Center Spacing	
Head Casing	12 Ga.	
Head Shaft Bearings	Sealed Take-up Ball Bearing	
Head Pulley	5-1/2" (139.7mm) Dia. w/ Vulcanized Rubber Lagging	
Buckets	6" X 4" (152.4mm X 101.6mm) HDPE	
Belting	6-1/2" (165.1mm) Wide PVC or Rubber	
Legging	14 Ga. Seam Welded Single Leg Columns	
Boot Casing	12 Ga.	
Boot Shaft Bearings	Sealed Two Bolt Flange Ball Bearing	
Boot Pulley	5-1/2" (139.7mm) Dia. Self-Cleaning Spoke Pulley	
Construction	Powder Coated Carbon, Galvanized, or Stainless Steel Optional Chain (See UC Series)	
Drive Package	Optional	
Motor	Optional	
Lining Options	AR Steel or Urethane	
*Units in Parenthesis are Metric (mm)		

Model U1TT

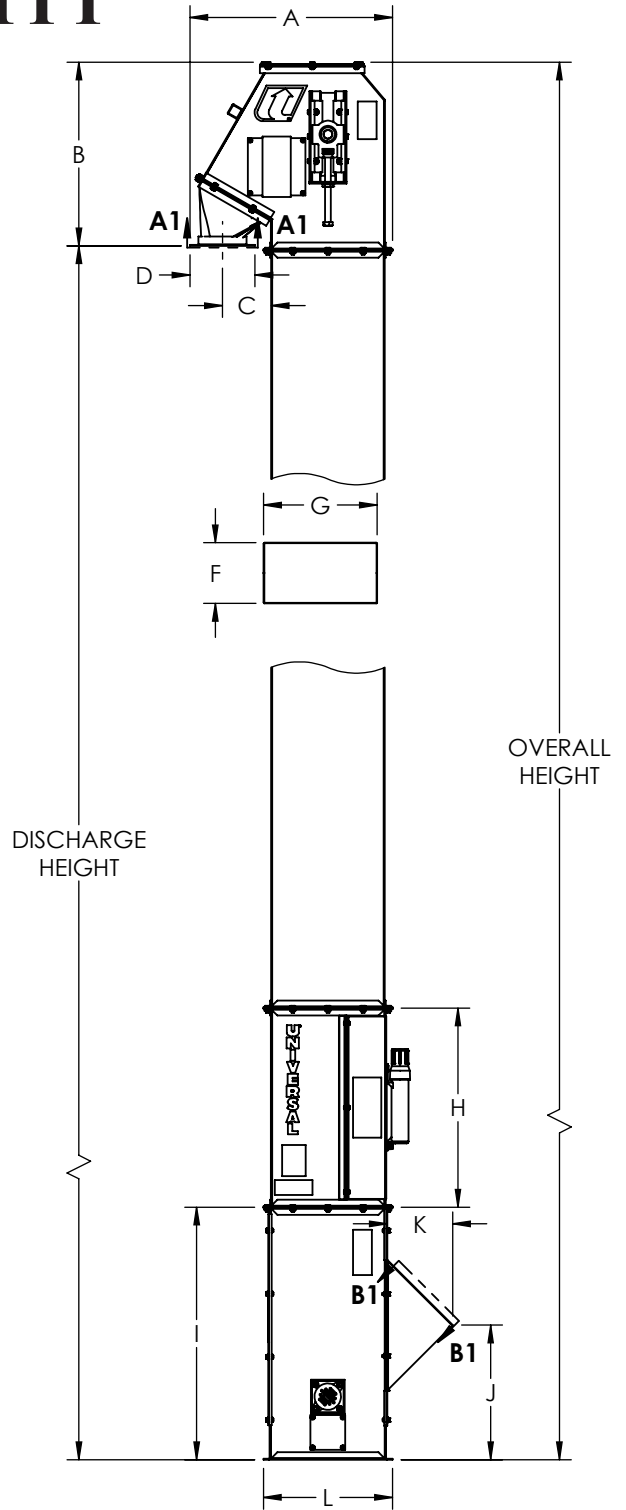
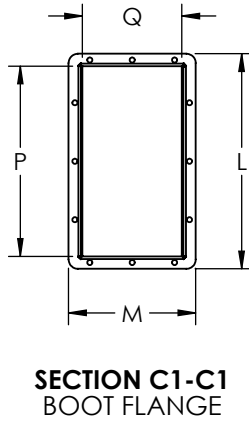
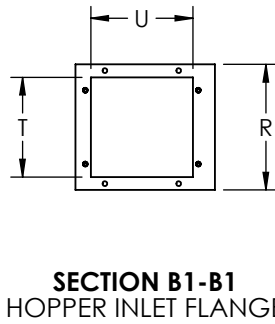
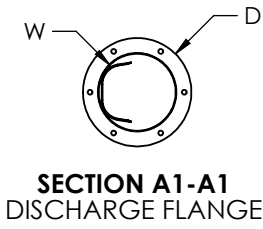
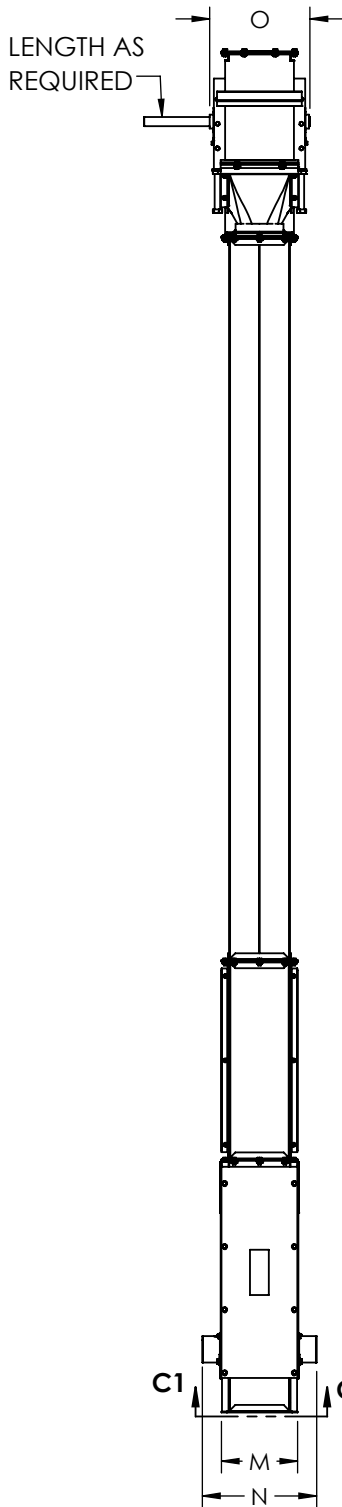

Unit	A	B	C	D	F	G	H	I	J	K	L	M	N	O	P	Q	R	T	U	W
in	27	24½	6½	8¾	8	15	26½	33½	18	8¾	17¼	10¼	15¼	13¼	15¼	8	10	8	8¼	6¼
mm	683	619	164	219	205	383	672	851	454	221	435	257	385	337	384	201	254	202	206	156

NOTE: Unit application, location and specifications determine the type, quantity and/or placement of electrical, electrical safety or other safety controls required. Whether these controls are supplied by Universal Industries or another supplier, all OSHA safety and health standards, the National Electrical Code and local codes must be met and followed. Because we constantly strive to provide the finest material handling equipment, establishing industry standards, specifications must remain subject to change without notice.